



Technical description

The slide gate valve are used to shut off or regulate the flow of gases (flue gas, air), bulk materials, liquids, etc. Thanks to its design (the blade completely extends outside the channel lumen when opening) the gate valve does not disturb the flow when fully open.

Materials

- structural steel, anti-corrosion protection - painting or galvanizing - working temp. up to 250°C,
- boiler steel, anti-corrosion protection - heat-resistant paint - working temp. up to 650°C,
- stainless or acid-resistant steel, anti-corrosion protection - etching and passivation - working temperature up to 550°C,
- heat-resistant steel, anti-corrosion protection - etching and passivation - working temperature up to 900°C,
- abrasion-resistant design for bulk materials.

Type of seal and geometric tightness

- without additional seals 95÷98%,
- with sealing bar in the body 98÷99%,
- with sealing bar in the body and soft sealing 99÷99,5%.

Design slide gate

- standard - full flow without deflector,,
- with deflector to protect the body and sliders from the medium
- slide gate equipped with additional nozzles for blowing with compressed air in order to avoid sticking of the knife,
- version with an additional scraper to remove sticky medium.

Flanges according to

- PN-EN 1092-1,
- DIN 86044,
- DIN 24154,
- individual according to customer requirements,
- drill-less version with welding tips.

Types of drives

- electric drive,
- pneumatic drive,
- hydraulic drive,
- manual drive.

Dimensional range [mm]

- 100x100 mm – 3000x3000 mm,
- other dimensions on request.

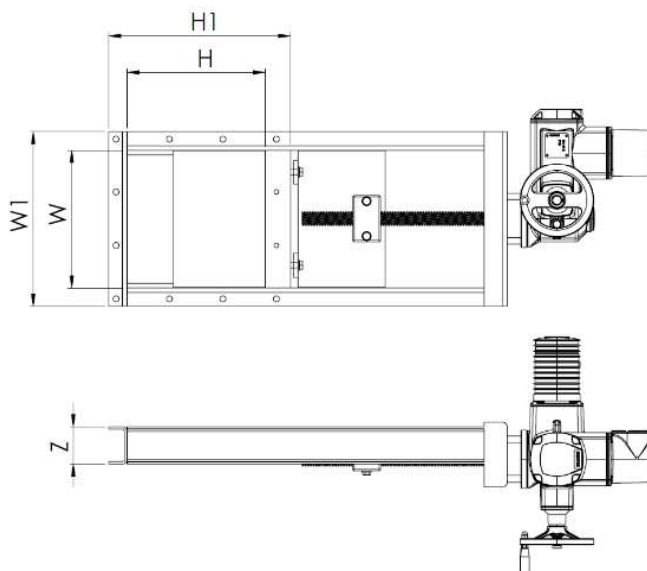

Dimensions of slide gate to be specified by the customer

W	H	W1	H1	Z

❗ If the customer does not specify the dimensions of the flange drilling company EES will offer the appropriate drilling to the size of the dumper. ❗

❗ Photos and drawings are for reference only ❗